



KONGSBERG
AUTOMOTIVE

CSBW

COMPACT STEER BY WIRE UNIT



AT A GLANCE

- > A COMPACT, LIGHTWEIGHT, ROTARY CONTROL, SUITABLE FOR ANY OFF HIGHWAY VEHICLE APPLICATION
- > DESIGNED FOR EASY STEER BY WIRE FUNCTION
- > EASY MOUNTING
- > CONFIGURED FOR CANBUS J1939 OUTPUT

PRODUCT DESCRIPTION

The CSBW – Compact Steer by Wire Unit is intended for use on any application where an electronic steering function is required. Output is configured to SAE J1939 protocol, but could be configured for a custom requirement.



CHINA: 1288 KANGQIAO EAST ROAD, 201319 PUDONG, CHINA // T: +86 2158134411

EUROPE: HLAVNÁ 48, 952 01 VRÁBLE, SLOVAKIA // T: +421 377 911 542

NORTH AMERICA: 300 SOUTH COCHRAN PO BOX 588 WILLIS, TX 77378, USA // T: +1 936 856 2971

WWW.KONGSBERGAUTOMOTIVE.COM



PRODUCT SPECIFICATIONS

PARAMETERS	SPECIFICATIONS
OPERATING TEMPERATURE	-40°C TO +85°C
IP RATING	IP67
CANBUS PROTOCOL	SAE J1939

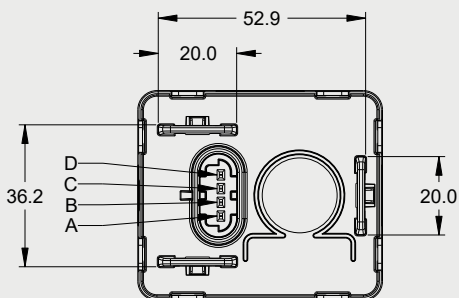
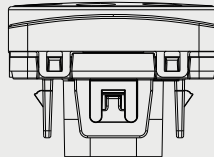
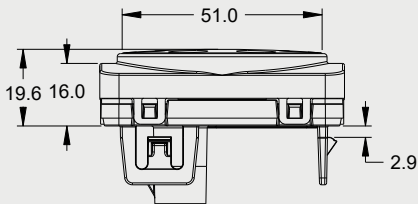
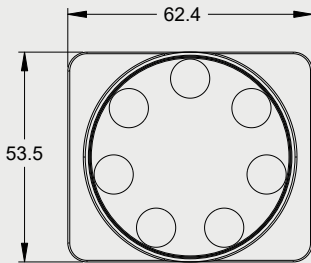

FEATURES

- > CANBUS SAE J1939 OUTPUT
- > 4 PIN METRIPACK 150 INTEGRATED CONNECTOR

OPTIONS

- > OUTPUT CAN BE CONFIGURED TO CUSTOM SPECIFICATION, IF REQUIRED